

Product Change Notice

Product Type: 60#80# Servo Motor

Models involved:

200W, 400W, 600W, 750W, 1000W

Change Description

Dear customers and partners:

In order to solve the delivery problem, our company has adjusted the appearance of some structural parts, and the product parameters are consistent with the original products. The specific changes are as follows.

Change details:

1. Adjusted the structural shape of the outlet parts (the schematic diagram before and after the installation of the connector version of the motor harness, see the attached picture 1).
2. The appearance of the motor has been adjusted, see attachment picture 2.
3. The length of the model without brakes is the same as that of the original product, and the length of the model with brakes has been adjusted (the length of the 60 brake model is shortened by 11mm. The length of the 80 brake model is shortened by 5mm). See the attached picture 3.
4. For the magnetic motor with brake, the magnet in the encoder magnetic holder is changed from $\phi 13$ to $\phi 20$ mm.

See attached!

The above changes are expected to start switching from June 10, 2023. If you have any questions, please feel free to contact our relevant personnel
Please be informed!

Wish
Good Luck!

Appendix:

(Figure 1)

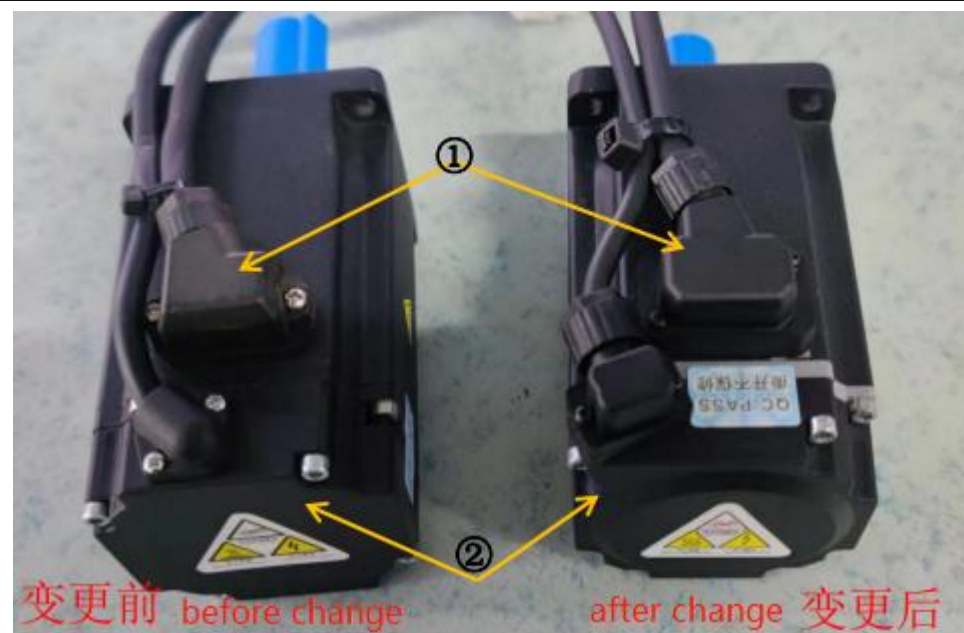



安装前 before installation



安装后 after installation

(Figure 2)

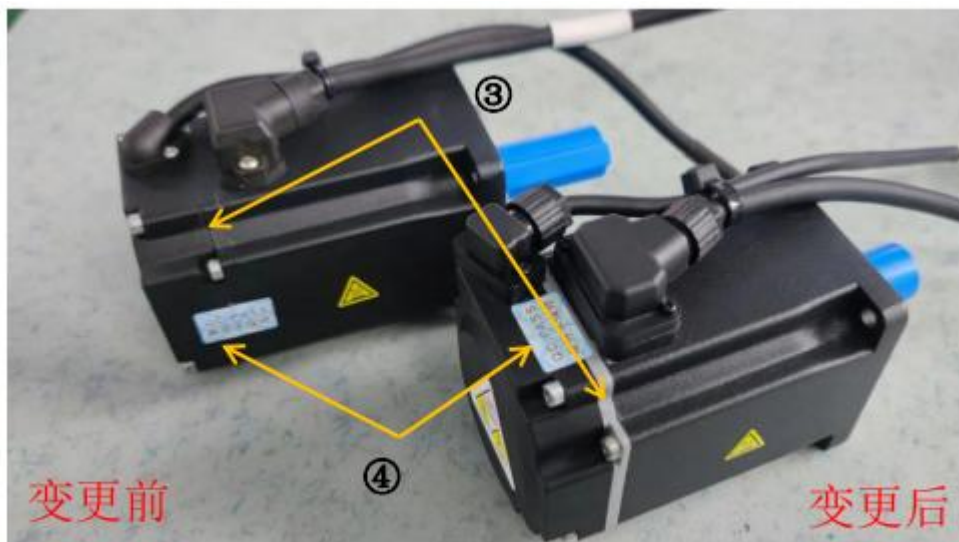

变更前

before change

变更后

after change



(Figure 3)

变更后
before change

after change
变更前



Before change

After change

